



A Division of Thiessen Products, Inc.

INSTRUCTION SHEET FOR No.1437, 1438, 1439, 1440, 1441, & 1442 BILLET FRONT HEAD MOTOR MOUNT



This new "A Cut Above™" billet engine mount has a more pleasing appearance and is stronger than an O.E.M. mount. The material is a premium grade of 6061T6 aluminum with optional chrome, polished, or black anodized finish. This mount comes with two allen head chrome screws and washers for mounting to the head. An optional hardware kit is available which includes a chrome plated Heim Joint link with chrome mounting hardware. Order hardware kit separately.

Front mounts are available for 2008 and later H-D® Touring Models or the same models using a JIMS® 120" or 131" engine.

OPTIONAL SOLD SEPERATELY



Billet Front Head Mount with two chrome allen screws and washers for stock H-D 2008 to present touring models:

- No.1437 - Chrome
- No.1438 - Polished
- No.1439 - Black anodized

Billet Front Head Mount with two chrome allen screws and washers for 2008 to present touring models with JIMS 120" or 131" engines.

- No.1440 - Chrome
- No.1441 - Polished
- No.1442 - Black anodized

Hardware kits include chrome plated Heim Joint assembly and chrome mounting hardware.

No.1444 - Use on any JIMS Billet Front Head Motor Mount. JIMS No.1437 through No.1442 or 2008 to present touring models..

**JIMS® IS NOT RESPONSIBLE FOR ANY DAMAGE OR INJURY RELATED YOUR WORK!
JIMS® IS NOT RESPONSIBLE FOR THE QUALITY AND SAFETY OF YOUR WORK!**

Perform all work per H-D service manual for appropriate year and model of the motorcycle you will be installing components to.

NOTE: PLEASE READ ALL INSTRUCTIONS COMPLETELY & THOROUGHLY BEFORE PERFORMING ANY WORK. IF YOU DO NOT KNOW WHAT YOU ARE DOING, DO NOT DO IT!

You and only you are responsible for the safety of your work and for you understanding the application and use of repair equipment, components, methods and concepts. Each and every step in this instruction sheet must be carefully and systematically performed safely by you. All information listed in this instruction sheet has been tested, re-tested and used daily in JIMS Research and Development Department.

PARTS AVAILABLE SEPARATELY FOR 1437, 1438, & 1439 MOUNT

No.	Qty.	Description	Part No.
1	1	Chrome motor mount	1429-3
2	1	Polished motor mount	1429-2
3	1	Black anodized motor mount	1429-1
4	1	Screw, 2.00" Lg.	1460
5	1	Screw, 1.5" Lg.	1459
6	2	Washer, chrome, thick	2216

PARTS AVAILABLE SEPARATELY FOR 1440, 1441, & 1442 MOUNT

No.	Qty.	Description	Part No.
1	1	Chrome motor mount	1429-3
2	1	Polished motor mount	1429-2
3	1	Black anodized motor mount	1429-1
4	1	Screw, 2" Lg.	1460
5	1	Screw, 1.5" Lg.	1459
6	2	Washer, chrome, thick	2216
7	1	Screw, 2.25" Lg.	2217

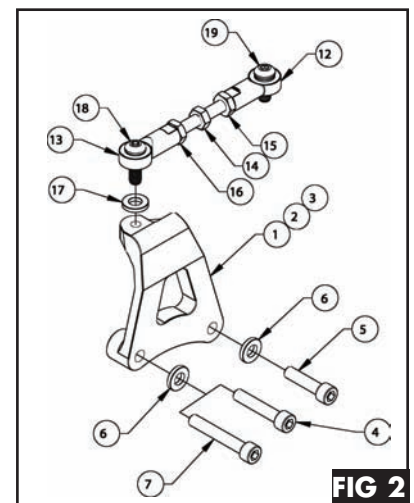
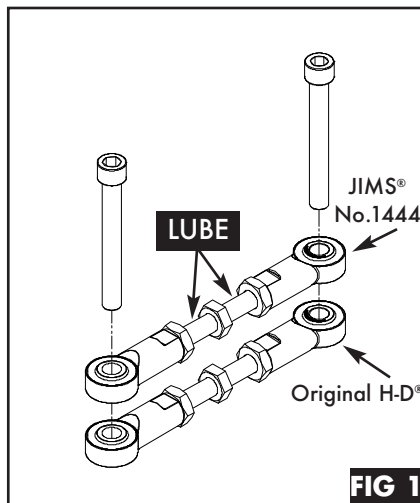

Performance Parts For Harley-Davidson Motorcycles



A Division of Thiessen Products, Inc.

INSTRUCTION SHEET FOR No.1437, 1438, 1439, 1440, 1441, & 1442 BILLET FRONT HEAD MOTOR MOUNT

PARTS AVAILABLE SEPARATELY FOR 1444 HARDWARE KIT

No.	Qty.	Description	Part No.
12	1	Chrome Heim joint RH	1445
13	1	Chrome Heim joint LH	1446
14	1	Jack screw	1427
15	1	Chrome jam nut, RH	1448
16	1	Chrome jam nut, LH	1449
17	1	Chrome washer, AN	1450
18	1	Chrome buttonhead 1" screw	1451
19	1	Chrome buttonhead 1-1/4" screw	1452
20	1	Instruction sheet	1437-IS

JIMS Tools needed to perform this service:

1. No. 964 FLH Power Train Alignment Tool (use on 2008 Models only)
2. See JIMS catalog for a complete listing of tools.

Other Hand Tools needed to perform this service:

1. H-D service manual for appropriate year and model for the motorcycle you will be repairing.
2. Allen wrench
3. Allen wrench
4. Socket
5. Loctite
6. Ratchet for above sockets
7. Torque wrench

Warning: Check that all the engine and transmission mounting hardware and components are in serviceable working order. On 2008 FLH

models, check vehicle alignment using Tool No. 964. If for any reason you need assistance please call JIMS TECH department at 805-482-6913.

Note: This in reference to JIMS 120" or 131" Engine application.

For head mounts that require mount spacers use screws No.1434 & 1443. For head mounts that don't require mount spacers use screws No.1434 & 1445.

Removal of top front motor mount components ** 2008 FLH to present

Note: For 2008 models, if you will be installing both the top motor mount No. 1437 thru 1442 and also stabilizer link No. 1444, then do not loosen the two stabilizer jam nuts on the stock link.

1. Remove top front. (STABLIZER LINK) H-D No. 16219-79C, save both screws H-D No. 4313 and No. 4775 they will be used for setting (adjusting) your new link for ** 2008 models only.
2. Remove front top motor mount from front head on all 2008 and later FLH models H-D No. 16321-08, (WELDMENT engine strap) set aside as you will not be using it.

Assembly of top Front Motor Mount Link (No. 1444) components 2008 FLH

Note : No.1444 is an optional Chrome Link Kit with hardware that must be ordered separately, or you have a choice of using your original H-D link and original link hardware.

1. Assemble your new Link No.1444, by first threading one jam nut and then the other nut (lightly lube threads with oil,) on each side of center adjusting link. **See Fig 1**
2. Lightly lube both Heim joints (Eyelets) and the I.D. threads on the ends of new adjusting link.
3. Thread the ends so they have about the same amount of thread engagement on each side. **See Fig 1.**
4. Using your stock hardware from Heim joints (H-D No. 4313) place both screws through your stock adjusting links eyelets. At the same time allow both screws to slide through your new adjusting link eyelets. You may need to either thread in or out the new Heim joints eyelets so both screws slip through all 4 eyelets. This will align the new joint to the setting of the old joint. Tighten both jam nuts to 10 to 12 ft-lbs. **See Fig 2.**

Installation of front top motor mount components 2009 FLH to present

1. Using the supplied hardware (two chrome 3/8 flat head Allen screws) install and torque the top head motor mount to the front head per your H-D service manual for 2009 to present.
2. Using the supplied hardware (two chrome 5/16 button head Allen screws) install and torque the Heim joint per your H-D service manual for 2009 to present.

Performance Parts For Harley-Davidson Motorcycles