



# INSTRUCTION SHEET FOR #2305

## TIMKEN® BEARING REMOVER

USE ON SPORTSTER 1957-76

USE TO REMOVE TIMKEN® BEARING FROM SPROCKET SHAFT WITHOUT REMOVING SHAFT FROM FLYWHEELS.



1. Refer to H-D® Service Manual for specifications on disassembling crankcases.
2. With flywheels installed on Flywheel Rebuilding Jig Tool, and sprocket shaft facing up and clamped tight in vice.
3. Install the two halves, No. 2305-1, with pulling edge under the bearing. Slip ring No. 1044-TS-2 over the two halves.
4. Lube threads of bolts No. 2007, slip on washer No. 2014 over each bolt. Align puller bar No. 2013 over the bolt holes in top of the two halves. Thread both bolts the same distance, going as deep as possible into No. 2305-1.

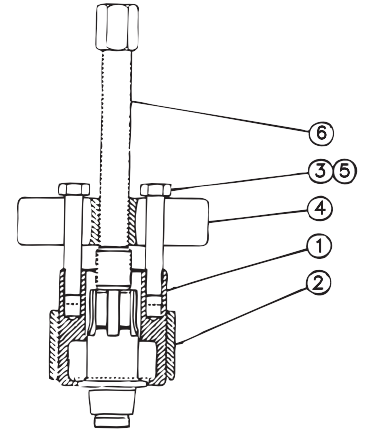

### PARTS AVAILABLE SEPARATELY

No.	Qty.	Description	Part No.
1	1	BEARING HOLDER - TWO HALVES	2305-1
2	1	RING	1044-TS-2
3	2	BOLT	2007
4	1	PULLER BAR	2013
5	2	FLAT WASHER	2014
6	1	SCREW	1024

5. Lube the threads and tip of screw No. 1024. Thread into puller bar until bearing is pulled from the sprocket shaft.

**CAUTION:** WEAR SAFETY GLASSES. EXCESSIVE FORCE MAY DAMAGE PARTS! SEE JIMS® CATALOG FOR OVER 100 OTHER TOP QUALITY PROFESSIONAL TOOLS. THE LAST TOOLS YOU WILL EVER NEED TO BUY.

*"From the Track... To the Street!"*

555 DAWSON DRIVE, CAMARILLO, CA 93012 PHONE 805-482-6913 • FAX 805-482-9224



# INSTRUCTION SHEET FOR #2305

## TIMKEN® BEARING REMOVER

USE ON SPORTSTER 1957-76

USE TO REMOVE TIMKEN® BEARING FROM SPROCKET SHAFT WITHOUT REMOVING SHAFT FROM FLYWHEELS.



1. Refer to H-D® Service Manual for specifications on disassembling crankcases.
2. With flywheels installed on Flywheel Rebuilding Jig Tool, and sprocket shaft facing up and clamped tight in vice.
3. Install the two halves, No. 2305-1, with pulling edge under the bearing. Slip ring No. 1044-TS-2 over the two halves.
4. Lube threads of bolts No. 2007, slip on washer No. 2014 over each bolt. Align puller bar No. 2013 over the bolt holes in top of the two halves. Thread both bolts the same distance, going as deep as possible into No. 2305-1.

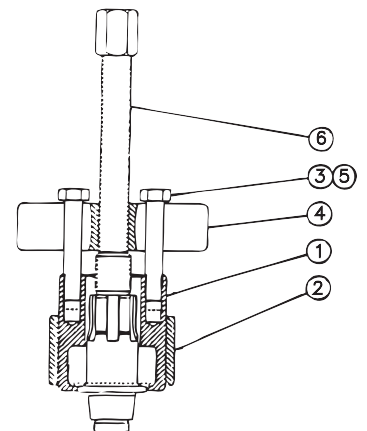

### PARTS AVAILABLE SEPARATELY

No.	Qty.	Description	Part No.
1	1	BEARING HOLDER - TWO HALVES	2305-1
2	1	RING	1044-TS-2
3	2	BOLT	2007
4	1	PULLER BAR	2013
5	2	FLAT WASHER	2014
6	1	SCREW	1024

5. Lube the threads and tip of screw No. 1024. Thread into puller bar until bearing is pulled from the sprocket shaft.

**CAUTION:** WEAR SAFETY GLASSES. EXCESSIVE FORCE MAY DAMAGE PARTS! SEE JIMS® CATALOG FOR OVER 100 OTHER TOP QUALITY PROFESSIONAL TOOLS. THE LAST TOOLS YOU WILL EVER NEED TO BUY.

*"From the Track... To the Street!"*

555 DAWSON DRIVE, CAMARILLO, CA 93012 PHONE 805-482-6913 • FAX 805-482-9224